



Electronic Pressure Switch



measuring
•
monitoring
•
analysing

PDL

Model: PDL-0...



Model: PDL-1...



- Switching range:
0,1...1 to 60...600 bar
- Temperature: max. 80 °C
- Repeatability:
≤ 1 % of full scale
- Material: brass
- Connection:
G 1/4, 1/4 NPT



KOBOLD companies worldwide:

ARGENTINA, AUSTRALIA, AUSTRIA, BELGIUM, BULGARIA, CANADA, CHILE, CHINA, COLOMBIA, CZECHIA, EGYPT, FRANCE, GERMANY, GREAT BRITAIN, HUNGARY, INDIA, INDONESIA, ITALY, MALAYSIA, MEXICO, NETHERLANDS, PERU, POLAND, REPUBLIC OF KOREA, ROMANIA, SINGAPORE, SPAIN, SWITZERLAND, TAIWAN, THAILAND, TUNISIA, TURKEY, USA, VIETNAM

KOBOLD Messring GmbH
Nordring 22-24
D-65719 Hofheim/Ts.
Head Office:
+49(0)6192 299-0
+49(0)6192 23398
info.de@kobold.com
www.kobold.com

Description

KOBOLD pressure meter/-monitor of model PDL are economical electronic pressure switches. The switch output can be adjusted on-site with an adjusting screw. With help of an elastic spring measuring element and by usage of Hall effect, up to 2 switching outputs can be generated for a given pressure. The switching outputs can be delivered optionally with N/O or N/C function. The small robust construction and different pressure connections make it an ideal unit for serial usage.

Dimensions

Model: PDL-0...

Model: PDL-1...

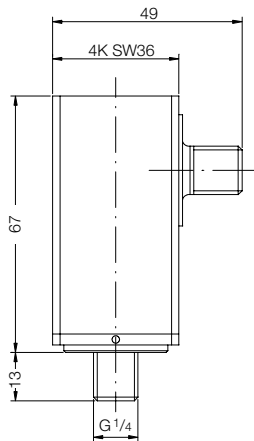
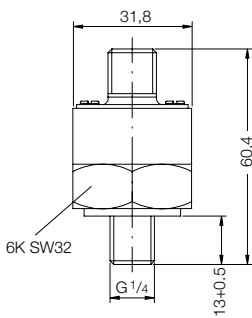

Applications

- Hydraulic and fluid systems
- Machine Building
- Equipment manufacture
- Refrigeration

Technical Data

Housing: PDL-0...: brass
PDL-1...: aluminium, anodised

Upper part: plastic

Connections: standard: G 1/4 male, brass
option: 1/4 NPT, brass
others on request

Measuring element: PDL-0...: capsule element, copper alloy
PDL-1...: spiral spring, st. steel 1.4571

Max. temperature: storage: -30 ... +80 °C
medium: -20 ... +80 °C
ambient: -20 ... +80 °C

Temperature comp. range: 0 ... 80 °C

Temperature influence: 0.4 % / 10 K

Overload limit: ≤ 10 bar: 4 times
≥ 16 bar: 2 times

Load change: 1 x 10⁶

Electrical connection: plug M12 x 1 (4-pole)
option: 1.5 m cable

Switching function: N/C or N/O, p-switching

Adjustability: 10 ... 100 % of full scale

Switch point adjustment: with help of adjusting screw

Repeatability: < 1 % of full scale

Switching hysteresis: ≤ 5 % of full scale,
≤ 10 % of full scale at 16 and 25 bar

Power supply: 10 ... 30 V_{DC}

Power rating: max. 100 mA (max. 30 V_{DC})

Protection: IP 65 (IP 67 by cable output)

Order Details (Example: PDL-0131 R2 B025)

Model	Description	Output	Connection	Switch point [bar] increasing pressure
PDL-01	Electronic pressure switch Brass housing with plug M12x1	31 = 1 N/O contact 32 = 2 N/O contacts 33 = 1 N/C contact 34 = 2 N/C contacts 35 = 1 N/O + 1 N/C	R2 = G 1/4 male N2 = 1/4 NPT	C315 = -0.9 to -0.05 B126 = 0.005 to 0.1 B025 = 0.05 to 1 B045 = 0.013 to 2.5 B055 = 0.2 to 4 B065 = 0.3 to 6 B075 = 0.5 to 10 B085 = 1.6 to 16 A095 = 2.5 to 25
PDL-11	Electronic pressure switch Aluminium housing with plug M12x1	31 = 1 N/O contact 32 = 2 N/O contacts 33 = 1 N/C contact 34 = 2 N/C contacts 35 = 1 N/O + 1 N/C	R2 = G 1/4 male N2 = 1/4 NPT	A115 = 3 to 60 A125 = 5 to 100 A135 = 8 to 160 A145 = 13 to 250 A155 = 20 to 400 A165 = 30 to 600